

Planning Permit No. A/735
APPROVED
Subject to the conditions in this office letter
A/b292/88/08/88

FOR MEMBER SECRETARY
MADRAS METROPOLITAN
DEVELOPMENT AUTHORITY

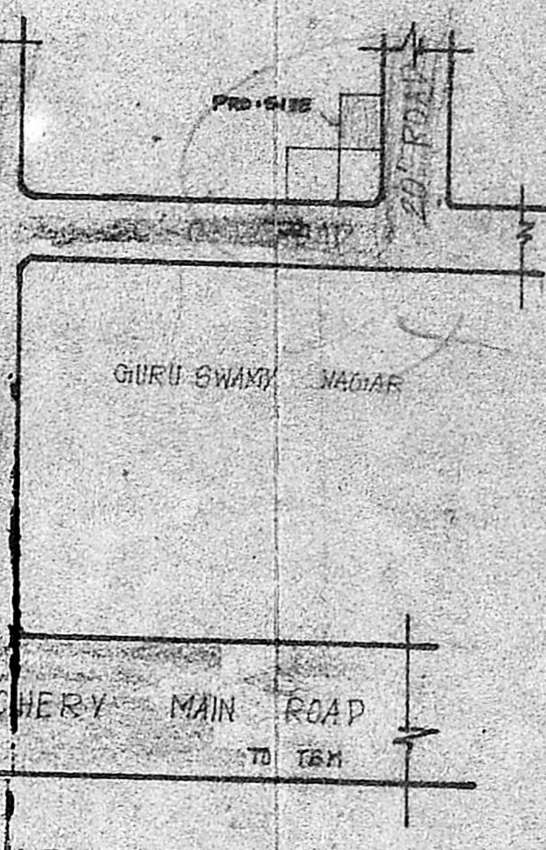

PLAN SHOWING THE PROPOSED
RESIDENTIAL BUILDING IN S: NO:
72/1 OF GURUSWAMY NAGAR
IN 14, GOWRIWAKAM VILLAGE
SAIDAPET TALUK, CHENGALPUT
DISTRICT. SCALE: 1:100+200
FOR KRISHNAVANI AMMAL

REFERENCE		
DOOR	D	100 x 213
DOOR	D ₁	91 x 193
DOOR	D ₂	75 x 186
WINDOW	W	122 x 122
WINDOW	W ₁	91 x 122
VENT	V	61 x 91

COLOUR INDEX	
PROPOSED	
ROAD	
SITE BOUNDRY	

	EXTENT	SQFT	SQMT
PLOT AREA	1900	177	
PLINTH AREA	263	24	
OPEN SPACE	1637	152	
COVERAGLE	14%		
F.S.I	0.14		

OWNER: DSKrishnamani

K. Komalarajam
K. KOMALARAJAM, L.C.E.
Consulting Engineer,
LICENSED SURVEYOR,
TAMBARAM MUNICIPALITY,
D, BANGALU AVENUE, KENNEDY ST,
TAMBARAM WEST,
MADRAS-600045

LICENSED SURVEYOR:

FRONT ELEVATION

MMDA [A]/PP No. /
C No. A/b292/88

Scrutiny
PART I 18585
PART II 122

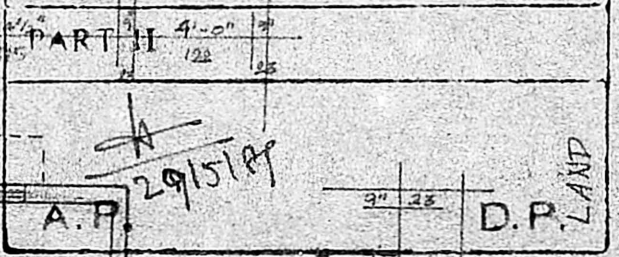

PLAN

SEC: ON 'AA'
SANKARA LINGAM LAND

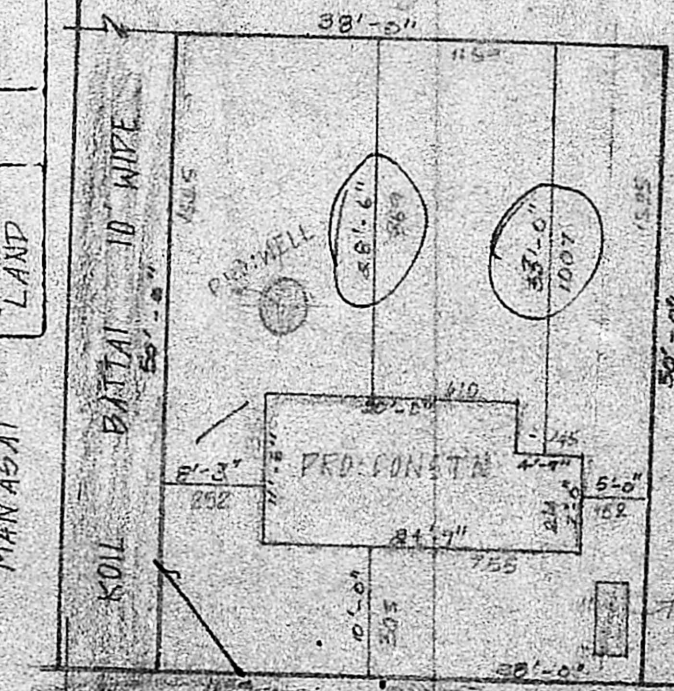

SITE PLAN 1:200

